

Supplement to the agenda for

Licensing sub-committee

Monday 12 March 2018

2.00 pm

**Committee Room 1, The Shire Hall, St Peter's Square,
Hereford, HR1 2HX**

	Pages
4. APPLICATION FOR A NEW PREMISES LICENCE IN RESPECT OF 'THE FUNCTION ROOM, LEOMINSTER SPORTS & SOCIAL CLUB, SOUTH STREET, LEOMINSTER. HR6 8JQ' - LICENSING ACT 2003.TO CONSIDER AN APPLICATION FOR A NEW PREMISES LICENCE IN RESPECT OF 'THE FUNCTION ROOM, LEOMINSTER SPORTS & SOCIAL CLUB, SOUTH STREET, LEOMINSTER. HR6 8JQ' - LICENSING ACT 2003.	3 - 20

Premises Licence Register

LUTON



Premises Licence Number

142690

This revision (reference number):

142690

Effective from:

23/07/2015

Part 1 - Premises details

Postal address of premises, or if none, ordnance survey map reference or description	
Stopsley Working Mens Club Limited 3 Putteridge Road	
Post town Luton	Post code LU2 8HG
Telephone number: 01582 611083	

Where the licence is time limited the dates		
Start Date	23/07/2015	End Date

Licensable activities authorised by the licence
Plays (Indoors) Films (Indoors) Indoor Sporting Events Boxing or Wrestling (Indoors) Live Music (Indoors) Recorded Music (Indoors) Performances of Dance (Indoors) Late Night Refreshment (Indoors and outdoors) Supply of Alcohol for consumption on the premises

The times the licence authorises the carrying out of licensable activities	
<u>Plays</u>	
Monday to Thursday	09.00 to 24.00
Friday to Saturday	09.00 to 01.00 (the following day)
Sunday	09.00 to 24.00
<u>Films</u>	
Monday to Thursday	09.00 to 24.00
Friday to Saturday	09.00 to 01.00 (the following day)
Sunday	09.00 to 24.00
<u>Indoor Sporting Events</u>	
Monday to Thursday	09.00 to 24.00
Friday to Saturday	09.00 to 01.00 (the following day)
Sunday	09.00 to 24.00
<u>Boxing or Wrestling</u>	
Monday to Thursday	09.00 to 24.00
Friday to Saturday	09.00 to 01.00 (the following day)
Sunday	09.00 to 24.00

<u>Live Music</u>	
Monday to Thursday	09.00 to 24.00
Friday to Saturday	09.00 to 01.00 (the following day)
Sunday	09.00 to 24.00
<u>Recorded Music</u>	
Monday to Thursday	09.00 to 24.00
Friday to Saturday	09.00 to 01.00 (the following day)
Sunday	09.00 to 24.00
<u>Performances of Dance</u>	
Monday to Thursday	09.00 to 24.00
Friday to Saturday	09.00 to 01.00 (the following day)
Sunday	09.00 to 24.00
<u>Late Night Refreshment</u>	
Monday to Thursday	23.00 to 24.00
Friday to Saturday	23.00 to 01.00 (the following day)
Sunday	23.00 to 24.00
<u>Supply of Alcohol</u>	
Monday to Thursday	09.00 to 24.00
Friday to Saturday	09.00 to 01.00 (the following day)
Sunday	09.00 to 24.00
Saturday/Sunday/Monday of Bank Holiday Weekends	09.00 to 01.00 (the following day)
New Year's Day	09.00 to 01.00 (the following day)
Christmas Eve, Boxing Day	09.00 to 01.00 (the following day)
Christmas Day	09.00 to 14.30, 19.00 to 24.00
New Year's Eve	09.00 to 03.30 (the following day)

The opening hours of the premises	
Monday	09.00 to 24.00
Tuesday	09.00 to 24.00
Wednesday	09.00 to 24.00
Thursday	09.00 to 24.00
Friday	09.00 to 01.00 (the following day)
Saturday	09.00 to 01.00 (the following day)
Sunday	09.00 to 24.00
Seasonal Variations	
New Year's Day	09.00 to 01.00 (the following day)
Christmas Eve, Boxing Day	
Christmas Day	09.00 to 01.00 (the following day)
New Year's Eve	09.00 to 14.30, 19.00 to 24.00
	09.00 to 03.30 (the following day)

Where the licence authorises supplies of alcohol whether these are on and/or off supplies

Supply of alcohol for consumption on the premises

Part 2

Name, (registered) address, telephone number and email (where relevant) of holder of premises licence

Stopsley Working Men's Club Ltd
3 Putteridge Road
Luton
LU2 8HG

Registered number of holder, for example company number, charity number (where applicable)

Not Applicable

Name, address and telephone number of designated premises supervisor where the premises licence authorises for the supply of alcohol

Stephen Francis McNally

Annex 1 - Mandatory conditions

1. Where a premises licence authorises the supply of alcohol:
 - a) No supply of alcohol may be made under the premises licence-
 - i. at a time when there is no designated premises supervisor in respect of the premises licence, or
 - ii. at a time when the designated premises supervisor does not hold a personal licence or his personal licence is suspended.
 - b) Every supply of alcohol under the premises licence must be made or authorised by a person who holds a personal licence.
2. Where the premises licence authorises the exhibition of films, the admission of children to the exhibition of any film is to be restricted in accordance with the recommendations made by the British Board of Film Classification.

In this condition "children" means persons aged under 18;

3. Where a premises licence includes a condition that at specified times one or more individuals must be at the premises to carry out a security activity, each such individual must be authorised to carry out that activity by a licence granted under the Private Security Industry Act 2001.

This condition is not imposed in respect of premises within paragraph 8(3)(a) of Schedule 2 to the Private Security Industry Act 2001 (c.12) (premises with premises licences authorising plays or films) and which is licensable conduct for the purposes of that Act (see section 3(2) of that Act)".

a) , or

- a) in respect of premises in relation to-
 - i. any occasion mentioned in paragraph 8(3)(b) or (c) of that Schedule (premises being used exclusively by club with club premises certificate, under a temporary event notice authorising plays or films or under a gaming licence), or
 - i. any occasion within paragraph 8(3)(d) of that Schedule (occasions prescribed by regulations under that Act).
- b) For the purposes of this condition-
 - i. "security activity" means an activity to which paragraph 2(1)(a) of that Schedule applies, (guarding of premises against unauthorised access, against outbreaks of disorder and against damage), and
 - i. paragraph 8(5) of that Schedule applies namely references in this condition to the occasion on which any premises are being used for a particular purpose include references to any time on that occasion when the premises are about to be used for that purpose, or have just been used for that purpose.

Premises Licences and Club Premises Certificates authorising the supply of alcohol for consumption on the Premises

FURTHER MANDATORY LICENSING CONDITIONS

With effect from 1 October 2014

1. The responsible person must ensure that staff on relevant premises do not carry out, arrange or participate in any irresponsible promotions in relation to the premises.
2. In this paragraph, an irresponsible promotion means any one or more of the following

activities, or substantially similar activities, carried on for the purpose of encouraging the sale or supply of alcohol for consumption on the premises—

(a) games or other activities which require or encourage, or are designed to require or encourage, individuals to—

- (i) drink a quantity of alcohol within a time limit (other than to drink alcohol sold or supplied on the premises before the cessation of the period in which the responsible person is authorised to sell or supply alcohol), or
- (ii) drink as much alcohol as possible (whether within a time limit or otherwise);

(b) provision of unlimited or unspecified quantities of alcohol free or for a fixed or discounted fee to the public or to a group defined by a particular characteristic in a manner which carries a significant risk of undermining a licensing objective;

(c) provision of free or discounted alcohol or any other thing as a prize to encourage or reward the purchase and consumption of alcohol over a period of 24 hours or less in a manner which carries a significant risk of undermining a licensing objective;

(d) selling or supplying alcohol in association with promotional posters or flyers on, or in the vicinity of, the premises which can reasonably be considered to condone, encourage or glamorise anti-social behaviour or to refer to the effects of drunkenness in any favourable manner;

(e) dispensing alcohol directly by one person into the mouth of another (other than where that other person is unable to drink without assistance by reason of disability).

2. The responsible person must ensure that free potable water is provided on request to customers where it is reasonably available.

3. (1) The premises licence holder or club premises certificate holder must ensure that an age verification policy is adopted in respect of the premises in relation to the sale or supply of alcohol.

(2) The designated premises supervisor in relation to the premises licence must ensure that the supply of alcohol at the premises is carried on in accordance with the age verification policy.

(3) The policy must require individuals who appear to the responsible person to be under 18 years of age (or such older age as may be specified in the policy) to produce on request, before being served alcohol, identification bearing their photograph, date of birth and either—

- (a) a holographic mark, or
- (b) an ultraviolet feature.

4. The responsible person must ensure that—

(a) where any of the following alcoholic drinks is sold or supplied for consumption on the premises (other than alcoholic drinks sold or supplied having been made up in advance ready for sale or supply in a securely closed container) it is available to customers in the following measures—

- (i) beer or cider: ½ pint;
- (ii) gin, rum, vodka or whisky: 25 ml or 35 ml; and
- (iii) still wine in a glass: 125 ml;

(b) these measures are displayed in a menu, price list or other printed material which is available to customers on the premises; and

(c) where a customer does not in relation to a sale of alcohol specify the quantity of alcohol to be sold, the customer is made aware that these measures are available.

With effect from 28th May 2014

1. A relevant person shall ensure that no alcohol is sold or supplied for consumption on or off the premises for a price which is less than the permitted price.

2. For the purposes of the condition set out in paragraph 1—

(a) “duty” is to be construed in accordance with the Alcoholic Liquor Duties Act 1979;

(b) “permitted price” is the price found by applying the formula—

$$P = D + (D \times V)$$

where—

(i) P is the permitted price,

(ii) D is the rate of duty chargeable in relation to the alcohol as if the duty were charged on the date of the sale or supply of the alcohol, and

(iii) V is the rate of value added tax chargeable in relation to the alcohol as if the value added tax were charged on the date of the sale or supply of the alcohol;

(c) “relevant person” means, in relation to premises in respect of which there is in force a premises licence—

(i) The holder of the premises licence,

(ii) The designated premises supervisor (if any) in respect of such a licence, or

(iii) The personal licence holder who makes or authorises a supply of alcohol under such a licence;

(d) “relevant person” means, in relation to premises in respect of which there is in force a club premises certificate, any member or officer of the club present on the premises in a capacity which enables the member or officer to prevent the supply in question; and

(e) “value added tax” means value added tax charged in accordance with the Value Added Tax Act 1994.

3. Where the permitted price given by Paragraph (b) of paragraph 2 would (apart from this paragraph) not be a whole number of pennies, the price given by that sub-paragraph shall be taken to be the price actually given by that sub-paragraph rounded up to the nearest penny.

4. (1) Sub-paragraph (2) applies where the permitted price given by Paragraph (b) of paragraph 2 on a day (“the first day”) would be different from the permitted price on the next day (“the second day”) as a result of a change to the rate of duty or value added tax.

(2) The permitted price which would apply on the first day applies to sales or supplies of alcohol which take place before the expiry of the period of 14 days beginning on the second day.

Annex 2 - Conditions consistent with the Operating Schedule

1. Staff are to be trained to refuse to sell alcohol to any person who appears to be intoxicated.
2. CCTV must be kept in good working order and must be made available upon the request of an officer from the Local Authority or Police.
3. External doors are to be kept shut to avoid noise nuisance to residents in the vicinity.
4. The premises must adopt a 'Challenge 25' policy whereby any person who attempts to buy alcohol that appears to be under the age of 25 will be asked to provide acceptable identification.
5. Clear signage shall be displayed around the premises asking customer's to leave quietly.
6. Clear signage shall be displayed around the premises reminding parents that they are responsible for their children.
7. Staff must request all customers to leave the premises quietly and on time.
8. The premises licence holder shall take all reasonable steps to deal with disorderly behavior in the premises.
9. Door supervisors will be on duty in accordance with the requirements of Bedfordshire Police when a boxing or wrestling event is held at the premises.

Annex 3 - Conditions attached after a hearing by the licensing authority

Conditions attached to the licence at the panel hearing on 23rd July 2015.

1. All doors and windows are to be kept closed when music is playing in the premises.
2. Customers are not to use the smoking and garden areas marked on the plan attached to the premises licence after 21.00 on any day.

Annex 4 - Plans

Note: Plans may not be shown to any scale that may be specified in the drawing.

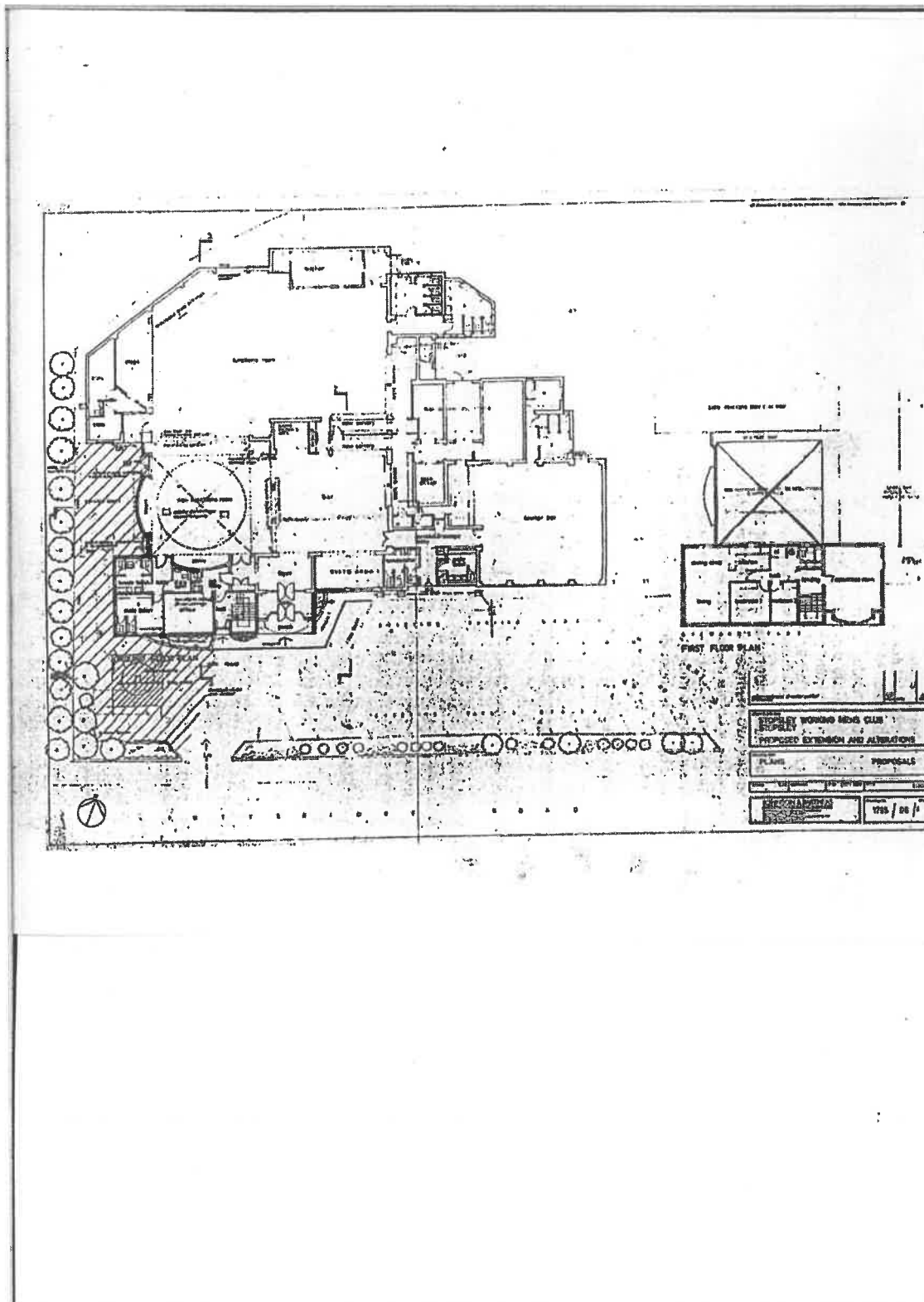

Club Premises Licence Register

LUTON

BOROUGH COUNCIL

Club premises certificate number

053085

This revision (reference number):

128538

Effective from:

25/04/2013

Part 1 – Club details

Name of club in whose name this certificate is granted and relevant postal address of club

Stopsley Working Mens Club

Address

3 Putteridge Road

Post town

Luton

Post code

LU2 8HG

Telephone number:

01582 611083

If different from above the postal address of club premises to which this certificate relates, if any, or if none, ordnance survey map reference or description

Not Applicable

Post town

Post code

Telephone number:

Where the club premises certificate is time limited the dates

Start Date

24/11/2005

End Date

Qualifying club activities authorised by the certificate

Indoor Sporting Events

Live Music (Indoors)

Recorded Music (Indoors)

Entertainment Similar to Music/Dance (Indoors)

Provision of Facilities for Dancing (Indoors)

Supply of Alcohol by or on behalf of the club to, or to the order of, a member of the club, and

Sale by Retail of Alcohol by or on behalf of the club to a guest of a member of the club

(for consumption on and off the premises)

The times the certificate authorises the carrying out of qualifying club activities

Indoor Sporting Events

On an occasional basis only, for the purpose of Darts/Pool finals & exhibition matches

Live Music

Saturday

20.30 to 23.30

Recorded Music

Sunday

19.00 to 23.00

Entertainment of a Similar Nature to Music/Dance

Wednesday

20.00 to 23.00

Provision of Facilities for Dancing

Wednesday

20.00 to 23.00

Saturday	20.30 to 23.30
Sunday	19.00 to 23.00
<u>Supply of Alcohol</u>	
Monday to Thursday	11.00 to 23.30
Friday to Saturday	11.00 to 00.30 (the following day)
Sunday	11.00 to 23.30
Saturday/Sunday/Monday of Bank Holiday Weekends	11.00 to 00.30 (the following day)
New Years Day	11.00 to 00.30 (the following day)
Christmas Eve, Boxing Day	11.00 to 00.30 (the following day)
Christmas Day	11.00 to 14.00, 19.00 to 23.30
New Years Eve	11.00 to 03.00 (the following day)

The opening hours of the club	
Monday	11.00 to 24.00
Tuesday	11.00 to 24.00
Wednesday	11.00 to 24.00
Thursday	11.00 to 24.00
Friday	11.00 to 01.00 (the following day)
Saturday	11.00 to 01.00 (the following day)
Sunday	11.00 to 24.00
Seasonal Variations	None
Non-Standard timings:	
Saturday/Sunday/Monday of Bank Holiday Weekends	11.00 to 01.00 (the following day)
New Years Day	11.00 to 01.00 (the following day)
Christmas Eve, Boxing Day	11.00 to 01.00 (the following day)
Christmas Day	11.00 to 14.30, 19.00 to 24.00
New Years Eve	11.00 to 03.30 (the following day)

Where the certificate authorises supplies of alcohol whether these are on and/ or off supplies	
<u>Alcohol – For consumption On and Off the premises</u>	
Monday to Thursday	11.00 to 23.30
Friday to Saturday	11.00 to 00.30 (the following day)
Sunday	11.00 to 23.30

Annex 1 - Mandatory conditions

Premises Licences and Club Premises Certificates authorising the supply of alcohol for consumption on the Premises

FURTHER MANDATORY LICENSING CONDITIONS

With effect from 6 April 2010

1. (1) The responsible person shall take all reasonable steps to ensure that staff on relevant premises do not carry out, arrange or participate in any irresponsible promotions in relation to the premises.
 - (2) In this paragraph, an irresponsible promotion means any one or more of the following activities, or substantially similar activities, carried on for the purpose of encouraging the sale or supply of alcohol for consumption on the premises in a manner which carries a significant risk of leading or contributing to crime and disorder, prejudice to public safety, public nuisance, or harm to children—
 - (a) games or other activities which require or encourage, or are designed to require or encourage, individuals to—
 - (i) drink a quantity of alcohol within a time limit (other than to drink alcohol sold or supplied on the premises before the cessation of the period in which the responsible person is authorised to sell or supply alcohol), or
 - (ii) drink as much alcohol as possible (whether within a time limit or otherwise);
 - (b) provision of unlimited or unspecified quantities of alcohol free or for a fixed or discounted fee to the public or to a group defined by a particular characteristic (other than any promotion or discount available to an individual in respect of alcohol for consumption at a table meal, as defined in section 159 of the Act);
 - (c) provision of free or discounted alcohol or any other thing as a prize to encourage or reward the purchase and consumption of alcohol over a period of 24 hours or less;
 - (d) provision of free or discounted alcohol in relation to the viewing on the premises of a sporting event, where that provision is dependent on—
 - (i) the outcome of a race, competition or other event or process, or
 - (ii) the likelihood of anything occurring or not occurring;
 - (e) selling or supplying alcohol in association with promotional posters or flyers on, or in the vicinity of, the premises which can reasonably be considered to condone, encourage or glamorise anti-social behaviour or to refer to the effects of drunkenness in any favourable manner.
2. The responsible person shall ensure that no alcohol is dispensed directly by one person into the mouth of another (other than where that other person is unable to drink without assistance by reason of a disability).
3. The responsible person shall ensure that free tap water is provided on request to customers where it is reasonably available

With effect from 1 October 2010

- 4.— (1) The premises licence holder or club premises certificate holder shall ensure that an age verification policy applies to the premises in relation to the sale or supply of alcohol.
- (2) The policy must require individuals who appear to the responsible person to be under 18 years of age (or such older age as may be specified in the policy) to produce on

request, before being served alcohol, identification bearing their photograph, date of birth and a holographic mark.

5. The responsible person shall ensure that—

(a) where any of the following alcoholic drinks is sold or supplied for consumption on the premises (other than alcoholic drinks sold or supplied having been made up in advance ready for sale or supply in a securely closed container) it is available to customers in the following measures—

(i) beer or cider: ½ pint;

(ii) gin, rum, vodka or whisky: 25 ml or 35 ml; and

(iii) still wine in a glass: 125 ml; and

(b) customers are made aware of the availability of these measures.

Annex 2 - Conditions consistent with the Club Operating Schedule

1. The rules relating to the classes of persons entitled to purchase intoxicating liquor shall not be altered without the consent of the Licensing Justices.
2. Indoor Sporting Events are to be provided on a very occasional basis only, for the purposes of darts/pool finals where the club premises is selected as a venue.
3. CCTV system to operate at the premises, covering at least the main entrance to the premises and the exterior car park area.
4. Club Management, Steward and Bar Staff to be made aware of the provisions of the Licensing Act 2003 to ensure compliance with relevant sections.
5. Admission to the premises to be confined to club members and their bona fide guests, and controlled through a central entry system.
6. Unaccompanied guests to be monitored during signing in process.
7. Members of guests behaving in a drunk or disorderly manner are to be refused service.
8. Misconduct by members or their guests to be reported to Club Committee for consideration.
9. Club to continue to comply with Health & Safety and Fire Precautions regulations.
10. Preventative and Control measures to be in place to ensure the safety of members, guests, staff and entertainers in matters identified in risk assessment.
11. Fire action notices to be displayed within the premises.
12. Emergency Escape routes to be clearly marked.
13. Appropriate signage to be displayed by exits requesting that members and guests leave the premises in a quiet manner, respectful of the needs of local residents.
14. All reasonable steps to be taken to avoid disturbance to neighbouring properties during performances of live/recorded music.
15. Under 18s to be allowed on premises only if accompanied by parents, grandparents or legal guardians.
16. Proof of age to be requested from young adults applying for membership of the club.
17. Appropriate signage to be displayed advising of provisions for supply of age-restricted products.

Embedded Restrictions applied on conversion of Club Registration Certificate

1. Alcohol shall not be sold or supplied except during permitted hours.

In this condition, permitted hours means the times shown on the Premises licence.

The above restrictions do not prohibit:

- a) during the first thirty minutes after the above hours, the consumption of the alcohol on the premises;
- b) during the first thirty minutes after the above hours, the taking of alcohol from the premises, unless the alcohol is supplied or taken in an open vessel;
- c) during the first thirty minutes after the above hours, the consumption of the alcohol on the premises by persons taking meals there if the alcohol was supplied as ancillary to the meals;

the supply to, or consumption by, any person of alcohol in any premises where they are residing

Annex 3 - Conditions attached after a hearing by the licensing authority

1. The licence holder shall install a sign in the Club's car parking area drawing Members and their guests attention to the fact that the premises are situated in a residential area and therefore all Members and their guests should leave in an orderly and quiet manner.
2. The licence holder shall ensure that there are at least two public announcements made after 11.00 p.m. reminding Members and their guests of the need to leave the premises in a quiet and orderly manner due to the fact that the premises are situated in a residential area.
3. The licence holder shall ensure that at least two of the Club's Committee Members and/or two members of staff are present in the Club's car parking area at least one half hour before the end of the time when the premises are open for the supply of alcohol on Fridays and Saturdays and that they remain so present until all the Members and their guests have left the premises to ensure that they leave in a quiet and orderly manner due to the fact that the premises are situated in a residential area.

Annex 4 - Plans

Note: Plans may not be shown to any scale that may be specified in the drawing.

Note: Plans may not be shown to any scale that may be specified in the drawing.

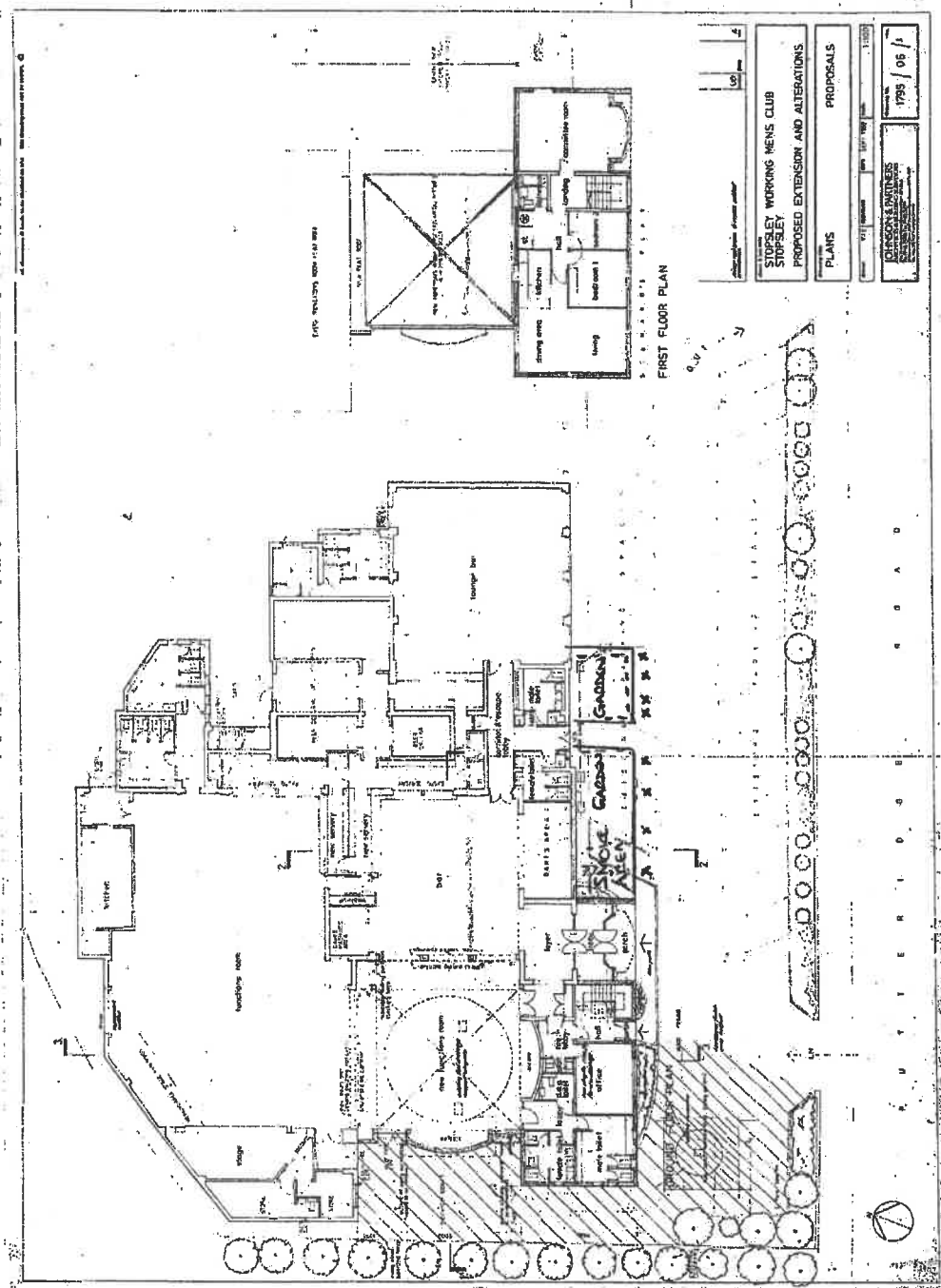

X FIXED ROLLER - ROPED BETWEEN

